





## altek Regulators

altek have been manufacturing regulators for use in plant protection equipment for over 30 years. There are many tens of thousands of sprayers around the world fitted with altek regulators providing reliable service to their operators.

Today altek regulating products are manufactured using the very latest technology in our modern design and production facility located in Germany.

Altek pressure regulators offer many distinctive features and benefits unique to altek products.

Altek offer three versions of pressure regulators: Mechanical constant pressure, Mechanical proportional regulator and Electrical proportional regulator.

The following pages provide an overview of these products.



## Pressure Regulator electrical

The pressure regulator divides the total pump output and controls the volume of liquid required for the spray boom. The surplus volume is sent back to the tank as return flow. In this function the regulator is an important component in terms of precise and economic spraying.

The electrical regulator 400 from altek has some specific advantages:

The housing ports are Altek AS40 connectors. This allows an easy and cost saving assembly process. Thanks to the altek quick-fit components range functional units can be assembled easily. The aerodynamic feature of the housing cause minimum flow losses

Due to the design it is possible to connect pumps with outputs up to 450 l/min. Two motor speeds allow individual application tasks. The piston guide is precise and free of clearance. Thus ensuring the correct application is assured. Micro switches at the end positions avoid any overload or overheating of the DC motor.



## Proportional regulator 120 · 200 · 300

altek Mechanical proportional regulators are available for use in sprayers with flow rates of 100-300 litres/min.

altek Electrical proportional regulators are available for use in sprayers with flow rates of 100-400 litres/min

**Proportional regulators (120/200) offer the following advantages:**

- A mechanical master shut-off valve with integrated circulation by means of a venture nozzle ensures an immediate pressure reduction in the spray lines is achieved when the master valve is closed. Advantage: Quick closure of the nozzle and no dripping
- The cross-sectional design of the regulators ensures that with speed changes within the ranges of + 25%, the flow rate is increased or decreased proportionally
- An integrated pressure relief valve pre-set at 10 bar protects the system from any pressure peaks
- The return-flow connection may be utilised for use with tank agitation
- Pressure gauge connection G $\frac{1}{4}$ " thread: A special sealing ring allows for adjustment of pressure gauge
- altek plug-in system for quick attachment of hose connection
- Regulators 300 & 400: For features and benefits of these products see specification sheets



## Constant Pressure Regulator 120 · 200

Our constant pressure regulators are particularly suited to the small and medium sized sprayers with flow rates of 70 – 200 litres/min, and offer users the following benefits:

- A mechanical master shut-off valve with integrated circulation by means of a venture nozzle ensures an immediate pressure reduction in the spray lines is achieved when the master valve is closed. Advantage: Quick closure of the nozzle and no dripping
- The Pressure regulator ensures a constant output is maintained even in the case of speed fluctuations
- An integrated pressure relief valve pre-set at 10 bar protects the system from any pressure peaks
- The return-flow connection may be utilised for use with tank agitation
- Pressure gauge connection G $\frac{1}{4}$ " thread: A special sealing ring allows for adjustment of pressure gauge
- altek plug-in system for quick attachment of hose connection



## Regulators · Electrical proportional regulator 400

### Electrical proportional regulator 400

- compact and flexible construction
- high flow rate
- flexible control response time
- modular unit
- quick and flexible assembly through Quick-Fit System
- comfortable manual emergency operation of for regulator and 3-way valves

Maximum pressure:	15 bar
Maximum flow rate:	450 l/min
Inlet-ø:	AS40
Return flow-ø:	ø39 hose connection
Outlet-ø:	AS40
Nominal voltage:	12 Volt
Material:	POM GF 25 stainless steel 1.4305 FPM und NBR seals

#### Recommended fittings inlet

Article-No.	Type
08354	Female hose tail AS40/ø20
80357	Female hose tail AS40/ø25
34232	Female hose tail AS40/ø33
34231	Female hose tail AS40/ø39

Other fittings are available upon request

#### Recommended fittings return flow

09184	Plug-in hose tail AS40/ø25/90° cpl
08874	Plug-in hose tail AS40/ø33/90° cpl
08275	Plug-in hose tail AS40/ø39/90° cpl
04595	Plug-in hose tail AS40/ø25 cpl
04581	Plug-in hose tail AS40/ø33 cpl
06247	Plug-in hose tail AS40/ø39 cpl
17409	Plug-in hose tail AS40/ø46 cpl

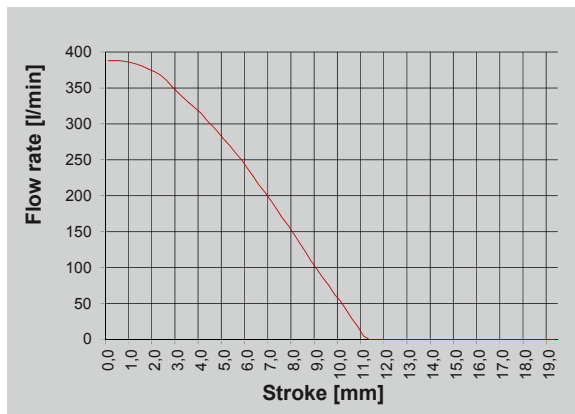

#### Regulator variant

Article-No.	Type	Electrical connection
81745	Electrical proportional regulator 400 approx 17 s	Cube plug DIN 175301
82200	Electrical proportional regulator 400 approx 12 s	Cube plug DIN 175301

A mm	B mm	C mm	AS1	AS2	D mm
180	105	300	40	40	39

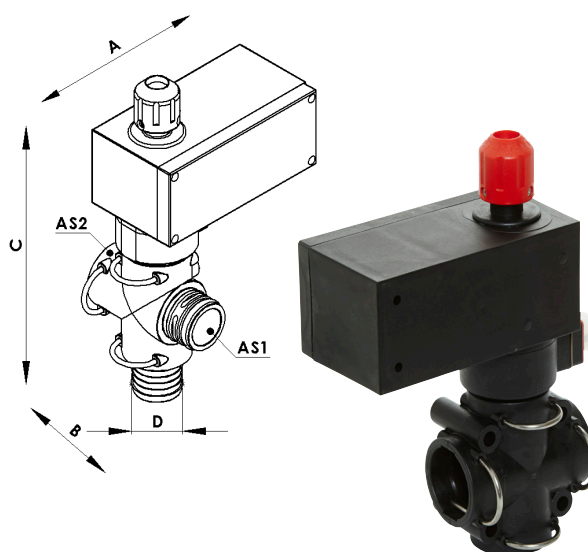



## Regulators · Proportional regulator 120

### Proportional regulator 120

- mechanical central shut off
- integrated suck back system
- cross-sectional control for a constant output quantity even in case of speed fluctuations
- integrated safety valve
- pressure gauge connection with G $\frac{1}{4}$ - thread
- compatible with the altek modular system

Maximum pressure:	10 bar
Maximum flow rate:	120 l/min
Inlet- $\phi$ :	AS30
Return flow- $\phi$ :	25 mm hose connection
Outlet- $\phi$ :	24 mm, tuned to fit the altek modular system
Material:	POM GF 25 stainless steel 1.4305 FPM und NBR seals, POM

A mm	B mm	C mm	D mm	E mm
225	125	135	64	42

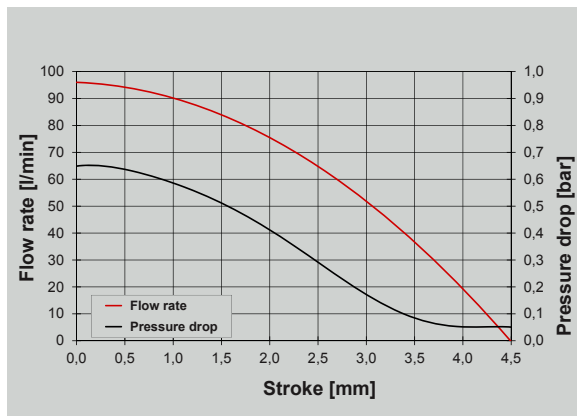
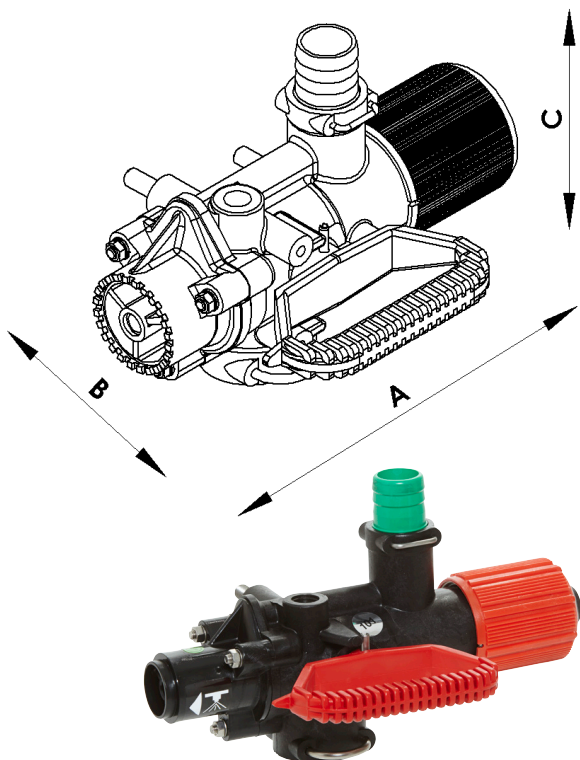

#### Regulator variant

Article-No.	Type	Article-No.
47008	1 Proportional regulator 120	32726
	1 Pressure filter with drain valve	34606
	3 Mechanical constant pressure valve 36/AS20	21920

More Regulator assemblies are available upon request

#### Recommended valves

Article-No.	Type
01400	Mechanical shut off valve 24/AS20
14578	Mechanical shut off valve 36/AS24
39767	Mechanical shut off valve 36/ $\phi$ 25mm
34622	Mechanical double valve 36/AS20
21920	Mechanical constant pressure valve 36/AS20

#### Recommended fittings inlet

08337	Plug-in hose tail AS30/ $\phi$ 25/90° cpl
33793	Plug-in hose tail AS30/ $\phi$ 33/90° cpl
81119	Plug-in hose tail AS30/ $\phi$ 25 cpl
01399	Plug-in hose tail AS30/ $\phi$ 33 cpl

More Fittings: see section AS30 Fittings



## Proportional regulator 200

- mechanical central shut off
- integrated suck back system
- cross-sectional control for a constant output quantity even in case of speed fluctuations
- integrated safety valve
- pressure gauge connection with G $\frac{1}{4}$ - thread
- compatible with the altek modular system

Maximum pressure:	10 bar
Maximum flow rate:	200 l/min
Inlet- $\phi$ :	AS30
Return flow- $\phi$ :	25 mm hose connection
Outlet- $\phi$ :	36 mm, tuned to fit the altek modular system
Material:	POM GF 25
	stainless steel 1.4305
	anodised cast aluminium
	FPM and NBR seals

### Recommended valves

Article-No.	Type
01400	Mechanical shut off valve 24/AS20
14578	Mechanical shut off valve 36/AS24
39767	Mechanical shut off valve 36/ $\phi$ 25mm
34622	Mechanical double valve 36/AS20
21920	Mechanical constant pressure valve 36/AS20
47942	Electrical shut off valve 36/AS24

### Recommended fittings inlet

08337	Plug-in hose tail AS30/ $\phi$ 25/90° cpl
33793	Plug-in hose tail AS30/ $\phi$ 33/90° cpl
81119	Plug-in hose tail AS30/ $\phi$ 25 cpl
01399	Plug-in hose tail AS30/ $\phi$ 33 cpl

More Fittings: see section AS30 Fittings

A mm	B mm	C mm	D mm	E mm
225	120	130	64	42

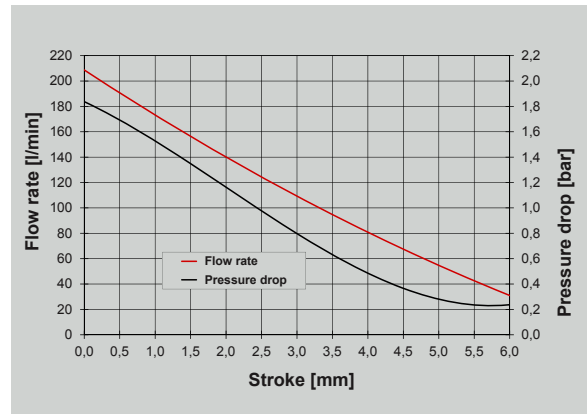

### Regulator variant

Article-No.	Type	Article-No.
31479	1 Proportional regulator 200 1 Pressure filter with drain valve 3 Mechanical constant pressure valve 36/AS20	32772 34606 21920
82615	1 Proportional regulator 200 1 Pressure filter with drain tap G 2 Electrical shut off valve 36/AS24	32772 34606 47942
82616	1 Proportional regulator 200 1 Pressure filter with drain tap G 4 Electrical shut off valve 36/AS24	32772 34606 47942

More Regulator assemblies are available upon request

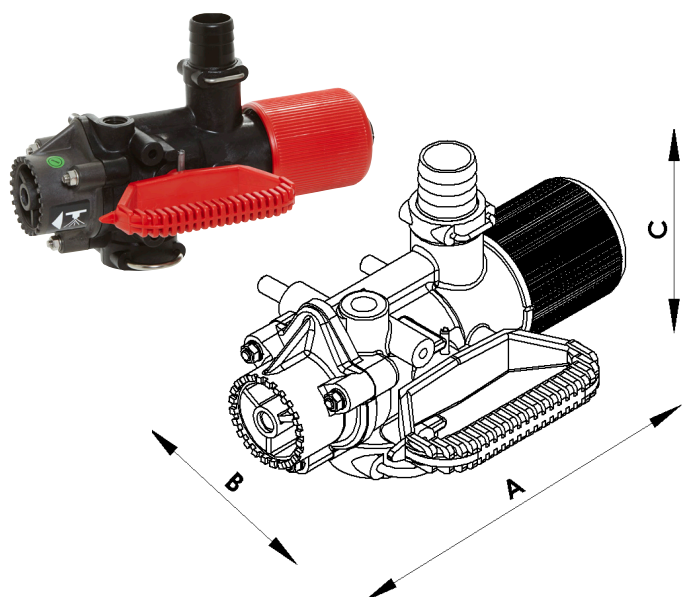





## Regulators · Manually proportional regulator 300

### Manual proportional regulator 300

- compact and flexible construction
- high flow rate
- self-contained working
- compatible when used with
- piston free of play

Maximum pressure:	15 bar
Maximum flow rate:	300 l/min
Inlet-ø:	AS40
Return flow-ø:	ø39 - hose connection
Outlet-ø:	AS40
Nominal voltage:	12 Volt
Material:	POM GF 25 stainless steel 1.4305 FPM und NBR seals

A mm	B mm	AS1	AS2	D mm
180	105	40	40	39

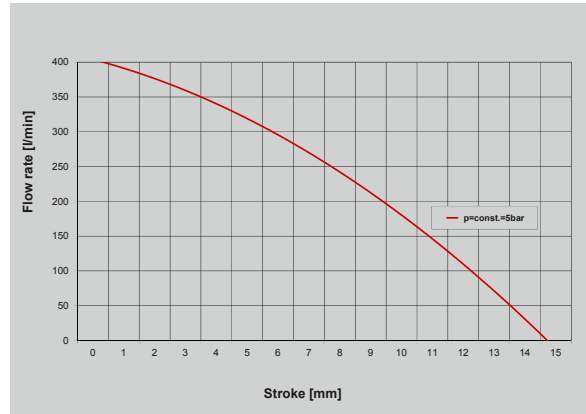
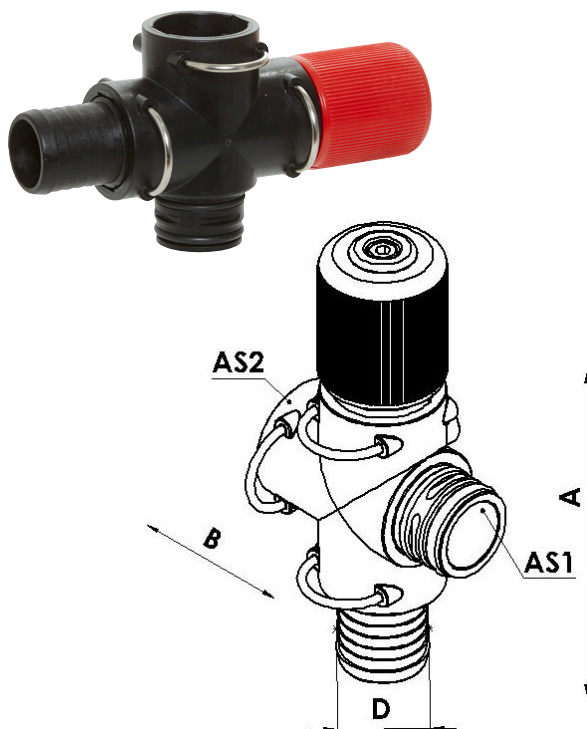

#### Regulator variant

Article-No.	Type
81873	Manual proportional regulator 300, with Cross piece
82199	Manual proportional regulator 300, with T-pieces

#### Recommended fittings inlet

Article-No.	Type
08354	Female hose tail AS40/ø20
80357	Female hose tail AS40/ø25
34232	Female hose tail AS40/ø33
34231	Female hose tail AS40/ø39

More Fittings: see section AS40 Fittings

#### Recommended fittings return flow

09184	Plug-in hose tail AS40/ø25/90° cpl
08874	Plug-in hose tail AS40/ø33/90° cpl
08275	Plug-in hose tail AS40/ø39/90° cpl
04595	Plug-in hose tail AS40/ø25 cpl
04581	Plug-in hose tail AS40/ø33 cpl
06247	Plug-in hose tail AS40/ø39 cpl
17409	Plug-in hose tail AS40/ø46 cpl



## Regulators · Constant pressure regulator 120

### Constant pressure regulator 120

- mechanical central shut off
- integrated suck back system
- cross-sectional control for a constant output quantity even in case of speed fluctuations
- integrated safety valve
- pressure gauge connection with G $\frac{1}{4}$ - thread
- compatible with the altek modular system

Maximum pressure:	10 bar
Maximum flow rate:	120 l/min
Inlet- $\phi$ :	AS30
Return flow- $\phi$ :	25 mm hose connection
Outlet- $\phi$ :	24 mm, tuned to fit the altek modular system
Material:	POM GF 25 stainless steel 1.4305 FPM and NBR seals

#### Options:

- 20 bar regulator available on request

#### Recommended valves

Article-No.	Type
01400	Mechanical shut off valve 24/AS20
14578	Mechanical shut off valve 36/AS24
39767	Mechanical shut off valve 36/ $\phi$ 25mm
34622	Mechanical double valve 36/AS20
21920	Mechanical constant pressure valve 36/AS20

#### Recommended fittings inlet

08337	Plug-in hose tail AS30/ $\phi$ 25/90° cpl
33793	Plug-in hose tail AS30/ $\phi$ 33/90° cpl
81119	Plug-in hose tail AS30/ $\phi$ 25 cpl
01399	Plug-in hose tail AS30/ $\phi$ 33 cpl

More Fittings: see section AS30 Fittings

A mm	B mm	C mm	D mm	E mm
240	120	130	64	42

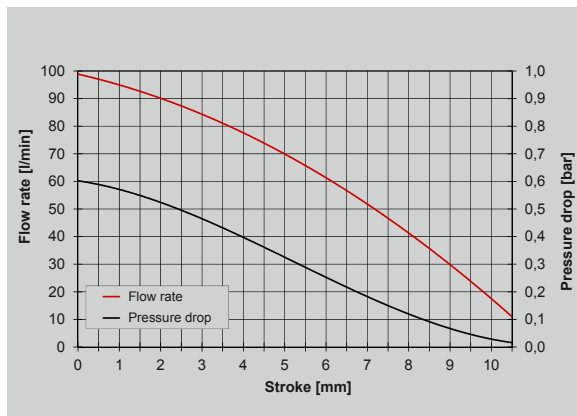

#### Regulator variant

Article-No.	Type	Article-No.
80146	1 Constant pressure regulator 120/100 cpl	26071
	1 Pressure filter 24/AS20/M65 with return flow	47010
	4 Mechanical shut off valve 24/AS20	01400
80148	1 Constant pressure regulator 120/100 cpl	34689
	1 Pressure filter 24/M65 with drain tap	34667
	2 Mechanical shut off valve 24/AS20	01400

More Regulator assemblies are available upon request

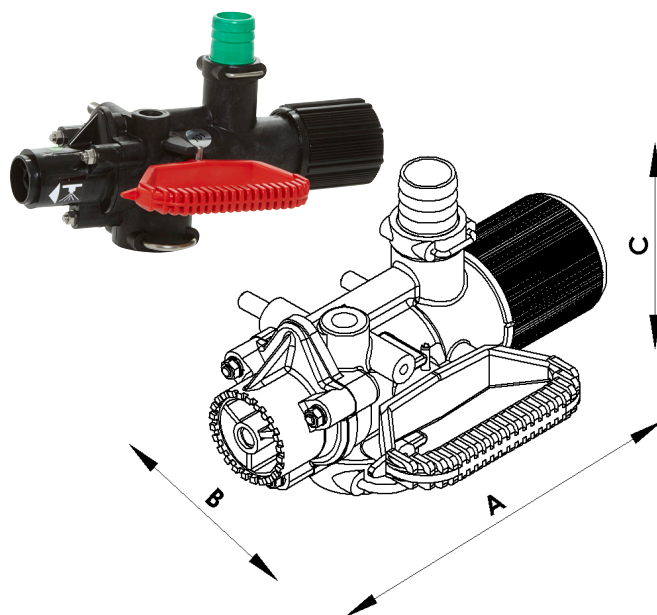



## Constant pressure regulator 200

- mechanical central shut off
- integrated suck back system
- pressure regulator for a constant spraying pressure
- integrated safety valve
- pressure gauge connection with G $\frac{1}{4}$ - thread
- compatible with the altek modular system

Maximum pressure:	10 bar
Maximum flow rate:	200 l/min
Inlet- $\phi$ :	AS30
Return flow- $\phi$ :	25 mm hose connection
Outlet- $\phi$ :	36 mm, tuned to fit the altek modular system
Material:	POM GF 25 stainless steel 1.4305 anodised cast aluminium FPM and NBR seals

### Options:

- 20 bar regulator available on request

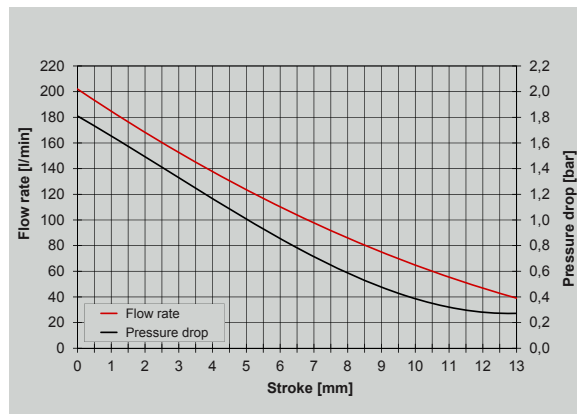

### Regulator variant

Article-No.	Type	Article-No.
34736	Constant pressure regulator 200	
More Regulator assemblies are available upon request		

A mm	B mm	C mm	D mm	E mm
220	120	135	64	42



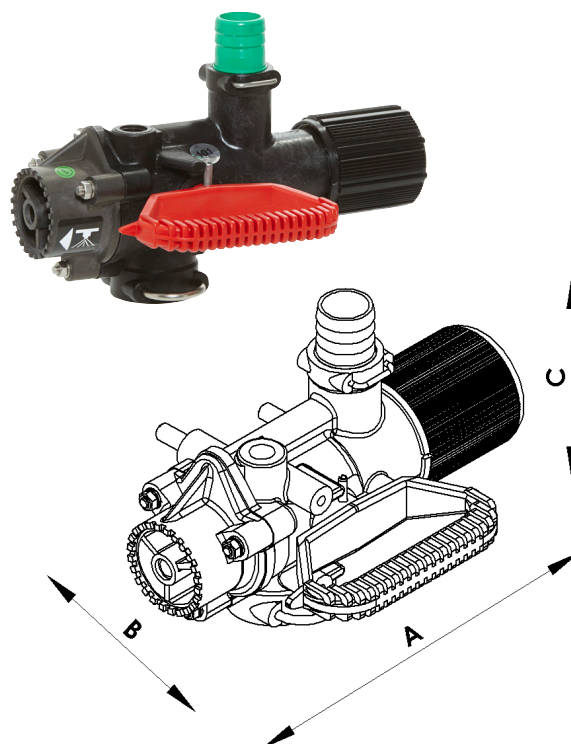



Recommended valves	
Article-No.	Type
01400	Mechanical shut off valve 24/AS20
14578	Mechanical shut off valve 36/AS24
39767	Mechanical shut off valve 36/ $\phi$ 25mm
34622	Mechanical double valve 36/AS20
21920	Mechanical constant pressure valve 36/AS20
Recommended fittings inlet	
08337	Plug-in hose tail AS30/ $\phi$ 25/90° cpl
33793	Plug-in hose tail AS30/ $\phi$ 33/90° cpl
81119	Plug-in hose tail AS30/ $\phi$ 25 cpl
01399	Plug-in hose tail AS30/ $\phi$ 33 cpl
More Fittings: see section AS30 Fittings	







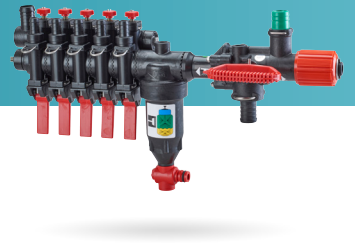

## Regulators · Regulator assemblies

Regulator assemblies		
Picture	Article-No.	Type
	31473	Regulator 120 Proportional DFIK+3MAV24/AS20
	35038	Regulator 120 Proportional 3MAV24/AS20
	41064	Regulator 120 Proportional DFIR+5MGV36/AS20
	41063	Regulator 120 Proportional DFIR+3MGV36/AS20
	25807	Regulator 120/101 Constant Pressure 3MAV24/AS20
	26071	Regulator 120 Constant Pressure 3MAV24/AS20



Regulator assemblies		
Picture	Article-No.	Type
	41058	Regulator 120/101 Constant Pressure DFiK+3MAV24/AS20
	31479	Regulator 200 Proportional DFi+3MGV36/AS20
	32726	Regulator 120/100 Proportional cpl
	32772	Regulator 200 Proportional cpl
	83056	Manifold 2xMAV36/AS24 red/yellow

More Regulator assemblies are available upon request – contact us!