



## P150

- linear steady state characteristics
- integrated hydraulic accumulator
- safe to run dry (liquid)
- self-priming up to 4 meters depth
- liquid fertiliser-proof (AHL/UAN)

Capacity at 5 bar:	150 l/min
Nominal speed:	540 U/min
Operating time pressure:	max. 15 bar
Short-term pressure:	max. 20 bar
Speed range:	450-600 U/min
Spline shaft:	DIN 9611/ISO 500
Standard working diaphragms:	4 x NBR
Accumulator diaphragms:	1 x NBR
Inlet- $\phi$ suction side:	AS50
Outlet- $\phi$ pressure side:	AS30
Lubrication:	Oil bath
Weight:	16,2 kg
Material:	Cast aluminium, partially anodised, NBR seals, POM, stainless steel: 1.4305

### Options:

- Desmopan® diaphragms
- Hydraulic drive

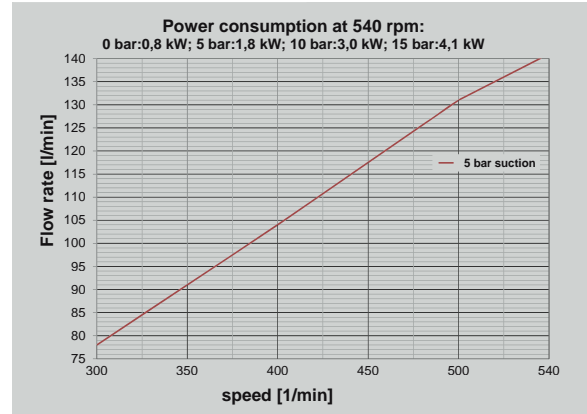

### Pump options

Article-No.	Type
82378	Piston diaphragm pump P150 with bracket and pto protection
More variations on request	

### Recommended fittings inlet (AS2)

17157	Plug-in hose tail AS50/ $\phi$ 46 cpl
17330	Plug-in hose tail AS50/ $\phi$ 46/90° cpl
22040	Plug-in hose tail AS50/ $\phi$ 39 cpl
24891	Plug-in hose tail AS50/ $\phi$ 39/90° cpl

### Recommended fittings outlet (AS1)

08337	Plug-in hose tail AS30/ $\phi$ 25/90° cpl
33793	Plug-in hose tail AS30/ $\phi$ 33/90° cpl
81119	Plug-in hose tail AS30/ $\phi$ 25 cpl
01399	Plug-in hose tail AS30/ $\phi$ 33 cpl

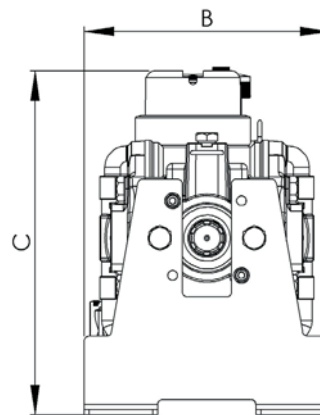
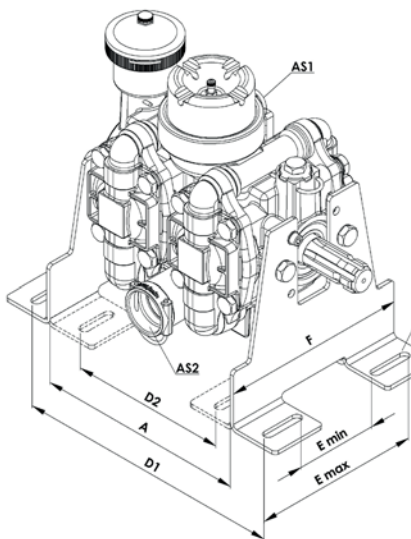

A	B	C
281	250	350,5
D1	D2	E <sub>Min</sub>
361	211	110
E <sub>Max</sub>	F	G
225	250	M12
Specified in mm		