



## Quick-fit valve

By utilising altek's plug-in system, the assembling time of the valves can be vastly reduced. Due to its compact and flexible construction, the valve can be perfectly used as section valve mounted close to the nozzle on the spray boom. Additionally its compactness allows

positioning and attaching the valve to the spray boom in a flexible manner. The electrical connection can be carried out through connection via cable, by cube plug DIN 175301 or AMP-plug.

### Characteristics:

- Flow rate up to 75 l/min at only 0,5 bar pressure loss
- Switching time: 0,5 s.
- Individually configurable boom section valves up to 15 valves
- High compatibility rate of valves to existing systems

### Electrical operation options of the motor drive:

- Control directly with 2 wires (plus/minus)
- Control with 3 wires (control circuit 7mA), 12 volt/ 0 volt = open/closed
- Control with 3 wires (control circuit 7mA), 12 volt/ 0 volt = closed/open



## Electrical Boom Section Valve . Quick-Fit Valve

### Quick-Fit Valve, 2-way

- fastest possible sprayer assembly with the altek plug-in system
- built extremely slim to be fully integrated into the spray boom
- three different electrical connections
- direct electrical control (plus/minus) or with control signal (7mA) by relay
- large flow rates at a low pressure drop
- for boom section hoses up to  $\varnothing 32$  mm
- modular building system

Maximum pressure: 12 bar  
 Voltage: 12 Volt  
 Control options: direct plus/minus or control signal 7mA by relay  
 Switch time: 0,5 s - control gear  
 Material: POM GF 25, stainless steel: 1.4305, FPM and NBR seals

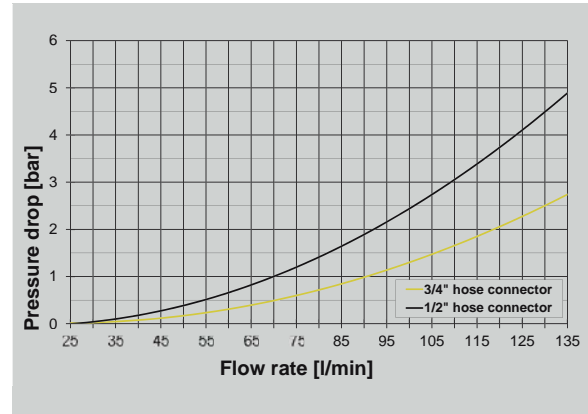

#### Recommended Fittings AS24

Article-No.	Type
34230	Female hose tail AS24/ $\varnothing 15$
34229	Female hose tail AS24/ $\varnothing 17$
34227	Female hose tail AS24/ $\varnothing 20$
80349	Female hose tail AS24/ $\varnothing 15/90^\circ$
80350	Female hose tail AS24/ $\varnothing 20/90^\circ$
47094	Female hose tail AS24/AS20 cpl

#### Recommended Fittings AS40

04595	Plug-in hose tail AS40/ $\varnothing 25$ cpl
04581	Plug-in hose tail AS40/ $\varnothing 33$ cpl
09184	Plug-in hose tail AS40/ $\varnothing 25/90^\circ$ cpl
80357	Female hose tail AS40/ $\varnothing 25$
34232	Female hose tail AS40/ $\varnothing 33$
47993	Blind cap AS40

#### Recommended Fittings AS30 with valve seat $120^\circ$

00420	Plug-in hose tail AS30/ $\varnothing 20$ cpl
81119	Plug-in hose tail AS30/ $\varnothing 25$ cpl
01399	Plug-in hose tail AS30/ $\varnothing 33$ cpl
33793	Plug-in hose tail AS30/ $\varnothing 33/90^\circ$ cpl
80378	Plug-in hose tail AS30/AS24 cpl

More Fittings: see AS plug-in fittings, AS30

#### Electrical drive

Three wire, control by relay  
 control signal (-): 12Volt/0Volt=closed/open

Three wire, control by relay  
 control signal (+): 12Volt/0Volt=open/closed

Two wire direct control - plus/minus

#### Electrical connections

Plug-in connection DIN-EN 175 301

Cable 1m

AMP - plug

# Electrical Boom Section Valve . Quick-Fit Valve

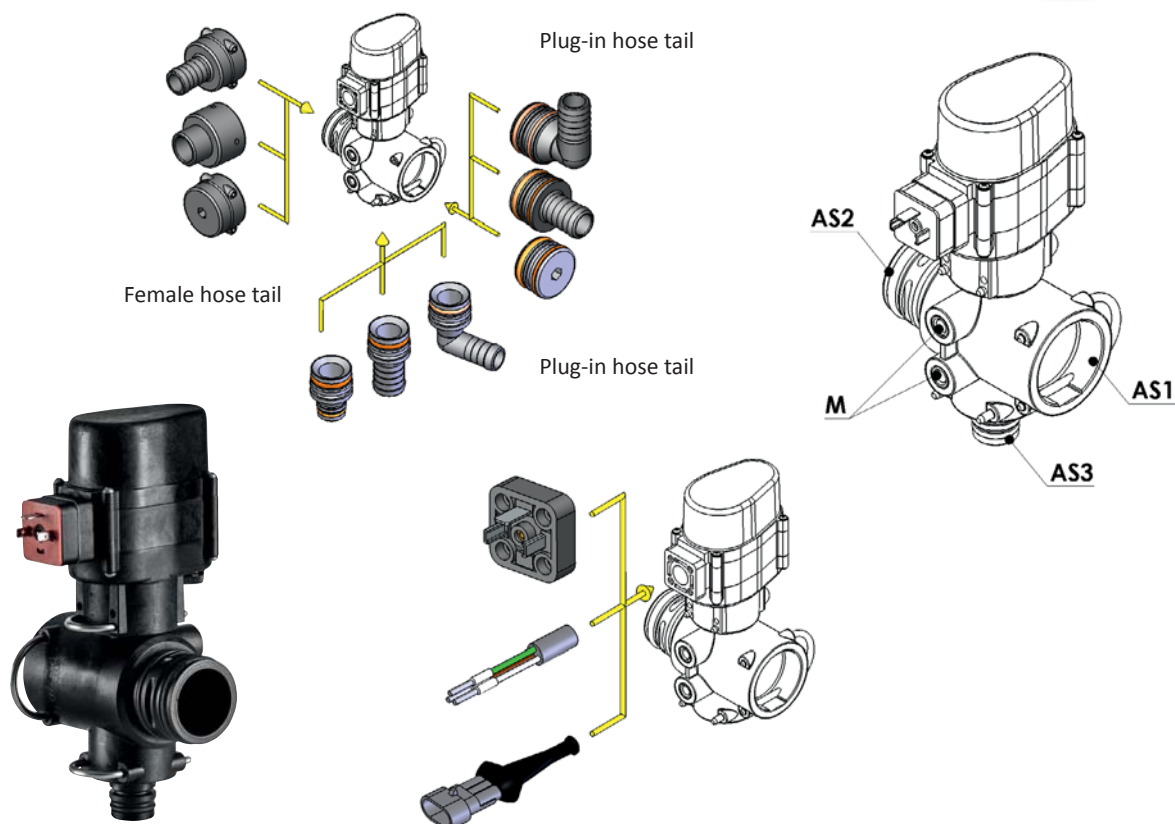

Valve with cable 1m						
Article-No.	Type	AS1	AS2	AS3	M	D
80553	Quick-Fit Valve, 2-WAY, AS24, 3-W, L=1m, (-)	40	40	24	M8	-
80556	Quick-Fit Valve; 2-WAY, AS24, 3-W, L=1m, (+)	40	40	24	M8	-
80558	Quick-Fit Valve, 2-WAY, AS24, 2-W, L=1m	40	40	24	M8	-
81534	Quick-Fit Valve, 2-WAY, AS30/ø25, L=1m, (+)	40	40	-	M8	ø25
Valve with plug connection DIN 175301						
80554	Quick-Fit Valve, 2-WAY, AS24, 3-W, DIN 175301, (-)	40	40	24	M8	-
80557	Quick-Fit Valve, 2-WAY, AS24, 3-W, DIN 175301, (+)	40	40	24	M8	-
81172	Quick-Fit Valve, 2-WAY, AS24, 2-W, DIN 175301	40	40	24	M8	-
81535	Quick-Fit Valve, 2-WAY, AS30/ø25, DIN 175301, (+)	40	40	-	M8	ø25
Valves with AMP-plug						
81533	Quick-Fit Valve, 2-WAY, AS24, 3-W, AMP, (-)	40	40	24	M8	-
80503	Quick-Fit Valve, 2-WAY, AS24, 3-W, AMP, (+)	40	40	24	M8	-
80559	Quick-Fit Valve, 2-WAY, AS24, 2-W, AMP	40	40	24	M8	-
81536	Quick-Fit Valve, 2-WAY, AS30/ø25, AMP, (+)	40	40	-	M8	ø25