

SERVICE INFORMATION

Date: 08/01/2013

Subject:

CENTRAL VALVE – OVERLOAD PROTECTION

altek International Ltd
The Office
Timaru Farm
Barton Road
Elsham, Brigg
North Lincolnshire
England
DN20 0LS.
Tel + 44 (0)1652 688 889
Fax + 44(0) 05603 129 813
sales@altekinternational.com
www.altekinternational.com

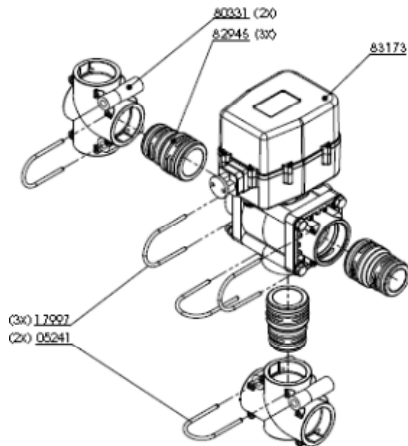

The 3 way central valve has an “OVERLOAD” protection thermal cut out fitted to the printed circuit. If the current draw is over 8.5 – 9.0 amp or the motor runs more than 2 seconds the overload system will cut the power to the motor.

If this error occurs you need to change the control current: from ON to OFF or from OFF to ON. Afterwards the valve goes back to the starting position.

If the error occurs during the returning of the valve to the starting position, (When the control current is OFF) the valve will first go to the required position when you switch it to ON. Afterwards you have to switch the valve OFF in order that it goes back to the starting position..

IMPORTANT: The cause of the overload should be found before re connecting, I.E. foreign object in the ball / dirty ball due to poor internal washing of the system from previous use.

The valves are also protected against incorrect power connection (fitting +/- the wrong way). This will also re set once the correct connection is made.