



P260/P260/P260

- linear steady state characteristics
- integrated hydraulic accumulator
- safe to run dry (liquid)
- self-priming up to 4 metres depth
- liquid fertiliser-proof (AHL/UAN)

Capacity at 5 bar:	3 x 260 l/min
Nominal speed:	540 U/min
Operating time pressure:	max. 15 bar
Short-term pressure:	max. 20 bar
Speed range:	450-600 U/min
Spline shaft:	DIN 9611/ISO 500
Standard working diaphragms:	12 Desmopan®
Accumulator diaphragms:	3 x NBR
Inlet- \varnothing suction side:	3 x G2" male; d=47
Outlet- \varnothing pressure side:	3 x AS30
Lubrication:	Oil bath
Weight:	86 kg
Material:	Cast aluminium, partially anodised, NBR seals, POM, stainless steel: 1.4305

Options:

- Hydraulic drive

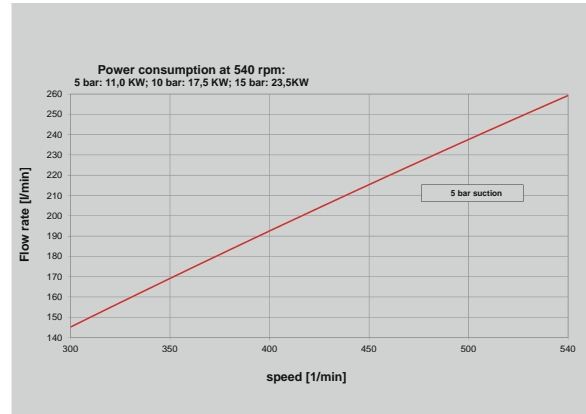

Pump options

Article-No.	Type
83347	piston diaphragm pump P260/P260/P260 with bracket and pto protection
More variations on request	
Recommended fittings inlet (AS2 / AS4 / AS6)	
--	Fittings to G3" male
Recommended fittings outlet (AS1 / AS2 / AS5)	
33793	Plug-in hose tail AS30/ \varnothing 33/90° cpl
01399	Plug-in hose tail AS30/ \varnothing 33 cpl

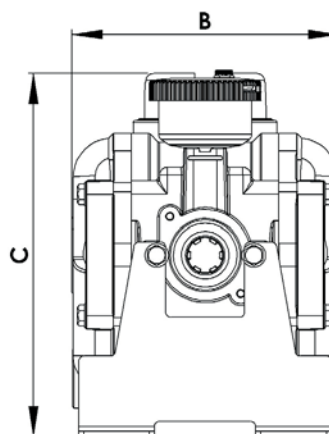
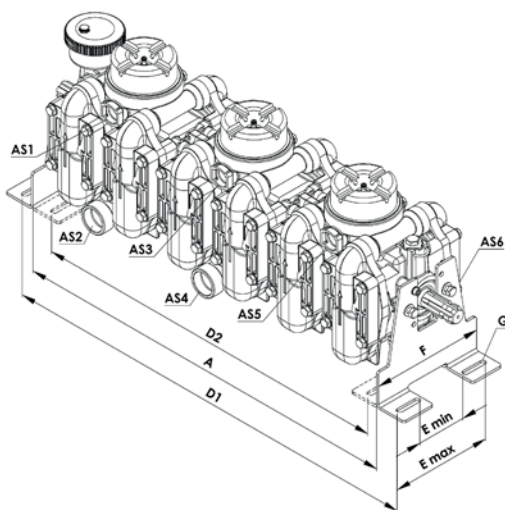

A	B	C
876	264	360
D1	D2	E _{Min}
956	806	110
E _{Max}	F	G
225	250	M12
Specified in mm		