



P500

- linear steady state characteristics
- integrated hydraulic accumulator
- safe to run dry (liquid)
- self-priming up to 4 meters depth
- liquid fertiliser-proof (AHL/UAN)

Capacity at 5 bar:	500 l/min
Nominal speed:	540 U/min
Operating time pressure:	max. 15 bar
Short-term pressure:	max. 20 bar
Speed range:	450-600 U/min
Spline shaft:	DIN 9611/ISO 500
Standard working diaphragms:	8 x NBR
Accumulator diaphragms:	1 x NBR
Inlet- \varnothing suction side:	2 x G3 male; d=75 mm
Outlet- \varnothing pressure side:	AS40
Lubrication:	Oil bath
Weight:	52,5 kg
Material:	Cast aluminium, partially anodised, NBR seals, POM, stainless steel: 1.4305

Options:

- Desmopan® diaphragms
- Hydraulic drive

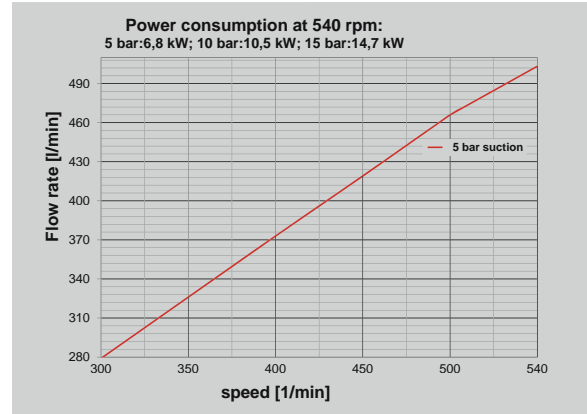

Pump options

Article-No.	Type
82656	Piston diaphragm pump P500
More variations on request	
Recommended fittings inlet (AS2 and AS4)	
--	Fittings to G3" male
Recommended fittings outlet (AS1 and AS3)	
08874	Plug-in hose tail AS40/ \varnothing 33/90° cpl
08275	Plug-in hose tail AS40/ \varnothing 39/90° cpl
04581	Plug-in hose tail AS40/ \varnothing 33 cpl
06247	Plug-in hose tail AS40/ \varnothing 39 cpl
80333	Blank Plug AS40 cpl

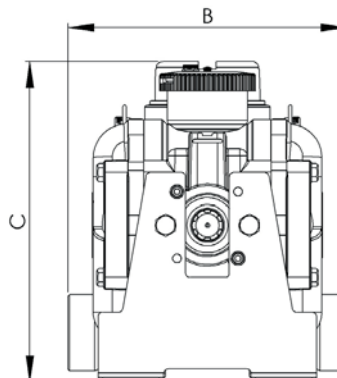
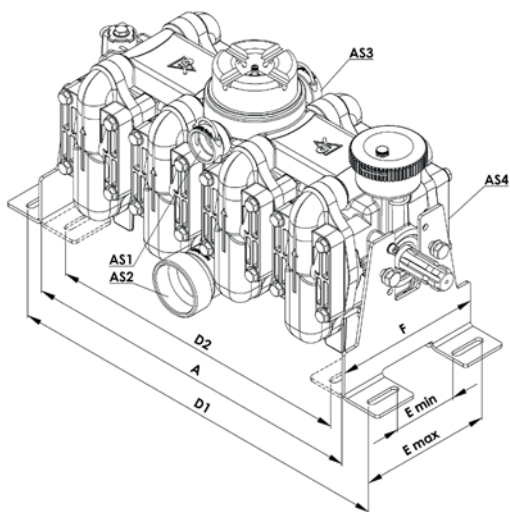

A	B	C
596	320	367,5
D1	D2	E _{Min}
676	526	110
E _{Max}	F	G
225	250	M12
Specified in mm		